

Ensim Level Switches

For top and side mounting – explosion proof

Ensim DX-ELB explosion proof level switches are used for measuring and checking the level of tanks in food, marine, boiler and storage tank applications.

- resistance to high temperature, up to 250°C
- up to 25 bar pressure
- long life contact structure
- operations in vertical or horizontal connection

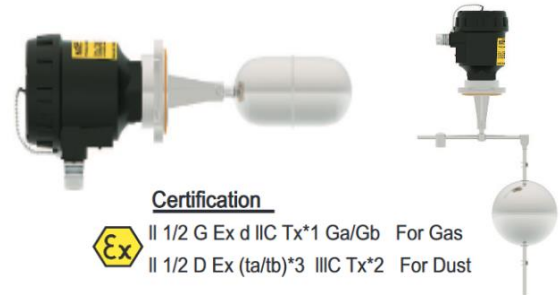

Working Principle:

Microswitch changes direction with the movement, occurring after magnet in float arm, moving by changing liquid level, affects magnet inside body, magnetically obtained contact information is assessed by transferring into applications such as pump, solenoid valve etc.

Options:

- Stainless steel external tank (by-pass)
- Protective below apparatus for fluids with granular.
- Counter flange
- Test apparatus

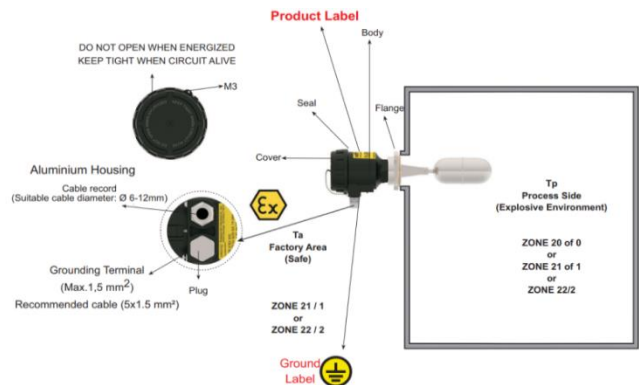

Applications:

- Palm Oil Refineries
- Oleo Chemical Plants
- Chemical
- Petro Chemical
- Paper & Pulp
- Energy & Power
- Water, Wastewater
- Manufacturing Process Industry

